



# TO LET

**White Lodge Close, Isleworth, TW7 6TR**  
**£1,900 Per Month**

**DBK**  
ESTATE AGENTS

- Available To Rent Immediately!
- Ground Floor Apartment
- Circa 654 Sq.Ft
- Two Bedrooms (Master with Ensuite)
- Open Plan Kitchen/ Reception Room
- Family Bathroom
- Secure Entry System
- Parking
- Patio Area
- Isleworth Station 0.5 miles

GROUND FLOOR  
654 sq.ft. (60.8 sq.m.) approx.

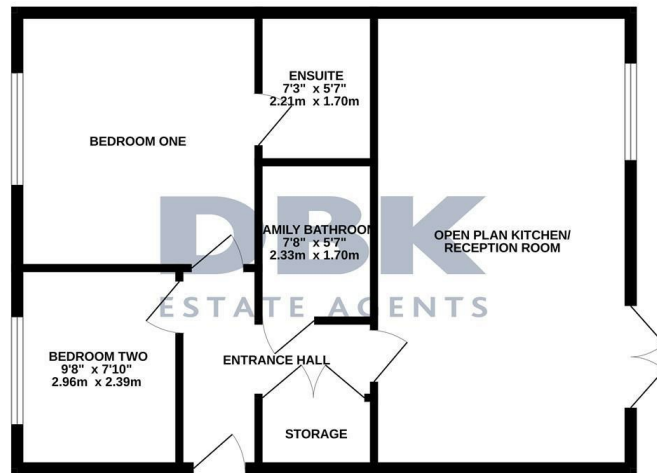

TOTAL FLOOR AREA: 654 sq.ft. (60.8 sq.m.) approx.  
Whilst every attempt has been made to ensure the accuracy of the floorplan contained here, measurements of doors, windows, rooms and any other items are approximate and no responsibility is taken for any error. Measurements are indicated, this plan is for guidance purposes only and should be used as a guide only and prospective purchaser. The services, systems and appliances shown have not been tested and no guarantee is given for their operability or efficiency can be given.  
Made with Metropix ©2024

## THE PROPERTY

Available To Rent Immediately!

This charming ground floor apartment offers approximately 654 sq.ft of well-designed living space perfect for those seeking comfort and convenience.

The property features two generously sized bedrooms, including a master suite complete with an ensuite bathroom. The heart of the home is the open-plan kitchen and reception room, which seamlessly blends functionality with style. A well-appointed family bathroom serves the rest of the apartment along with a large storage cupboard in the entrance hall.

Step outside to enjoy a patio area, ideal for relaxing or dining al fresco. The apartment also benefits from a secure entry system and comes with parking.

Sited in the heart of Old Isleworth the property is located within walking distance to an ample array of local amenities on South Street. For those commuting to The City there is the choice of Isleworth or St. Margarets Stations and for motorists the A4 and A316 can be found with easy access. Reputable schools include The Blue School CoFE Primary and Orleans Park School both scoring OUTSTANDING by OFSTED.